

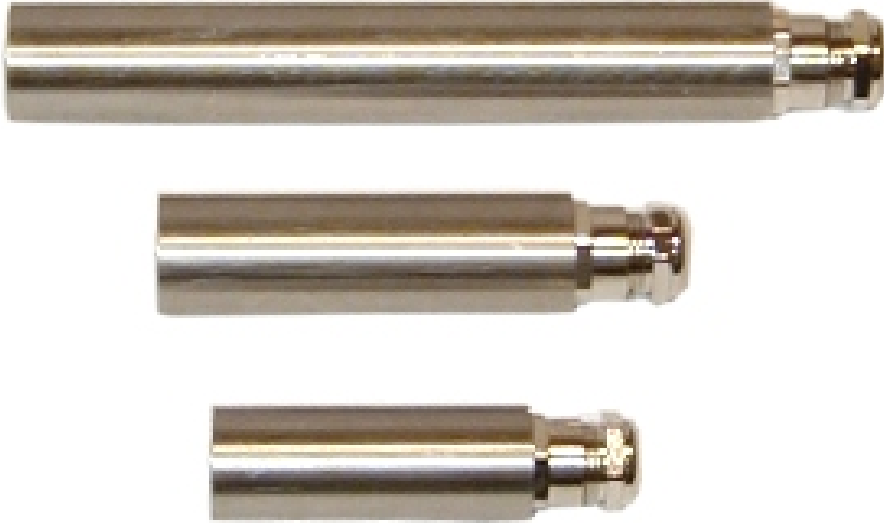

## MD9000 TYPE F & TYPE H REMOTE STAINLESS STEEL TUBULAR LENS



- **Standard 25 mm diameter housing for all lenses.**
- **Ambient temperature rating of 180°C (Type F) or 400°C (Type H).**
- **1°, 2°, 4° or 7° Spot Field of View.**
- **Detached air purge facility via lens holder.**
- **Used in conjunction with flexible armored fiber optic leads.**

### General Description

The MD9000 Type F and Type H Remote Stainless Steel Tubular Lenses are available in field of views from 1°, 2°, 4° and 7°, and ambient temperature ratings of 180°C (Type F) or 400°C (Type H).

These inexpensive lenses that are straightforward to install and extremely rugged construction. Ideal for product tracking and getting close to hot product.

If the sole purpose of the installation is the general tracking of hot product that is traveling down the center of the conveyor system, a 7° spot lens is normally adequate. The 4° spot lens, on the other hand, is used for similar installations that require a restricted field of view due to background IR, etc. The 1° or 2° spot lens is normally used in installations where the lens is going to be set a substantial distance from the target.

All the tubular housings use the same fiber optic cable in lengths available up to 15 meters.

## MODULOC<sup>®</sup> Technology - The Total Sensor Solution

## Dimensions

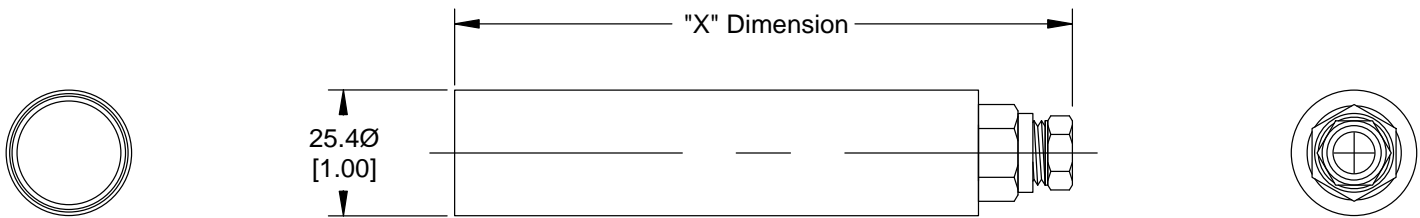

## General Specifications

Type F Lens	
<b>Housing Material:</b>	Stainless Steel, 25 mm diameter
<b>Lens Material:</b>	Tempered Crown Glass
<b>Fittings</b>	Nickel Plated Brass
<b>Fiber Optic Glands</b>	Neoprene
<b>Housing Rating:</b>	IEC IP66, DIN-89011, NEMA 3, 4, 12
<b>Temperature Rating:</b>	Type F: -20°C (-4°F) to +180°C (356°F)

Type H Lens	
<b>Housing Material:</b>	Stainless Steel, 25 mm diameter
<b>Lens Material:</b>	Tempered Crown Glass
<b>Fittings</b>	Brass
<b>Fiber Optic Glands</b>	Brass
<b>Housing Rating:</b>	IEC IP66, DIN-89011, NEMA 3, 4, 12
<b>Temperature Rating:</b>	Type H: -20°C (-4°F) to +400°C (752°F)

Type H & F Lens Information				
Lens Type	H1	F2/H2	F4/H4	F7/H7
<b>Field of View (FOV)</b>	1°	2°	4°	7°
<b>"X" Dimension (mm/in)</b>	190/7.48	130/5.12	110/4.33	80/3.15
<b>Scanned Area (mm/in) at 1 meter (39.37 in.)</b>	20/0.79	40/1.58	80/3.15	120/4.72

## MODULOC<sup>®</sup> Technology - The Total Sensor Solution

**MODULOC<sup>®</sup>**  
Control Systems

We reserve the right to alter specifications without prior notice. Specifications without tolerances are typical values.

Your Local Sales Representative:



Bulletin MC-9000-SR-09-01  
January 2009